

Soils Map

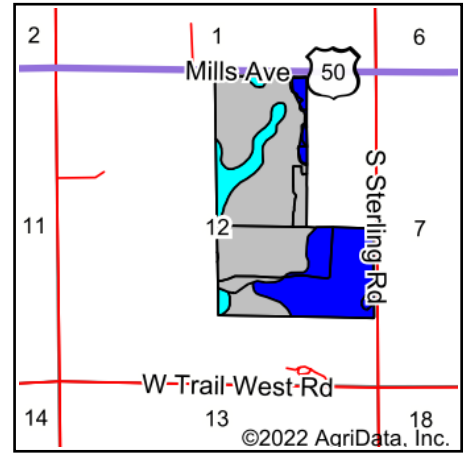

State: **Kansas**
 County: **Reno**
 Location: **12-24S-9W**
 Township: **Plevna**
 Acres: **176.22**
 Date: **9/22/2022**

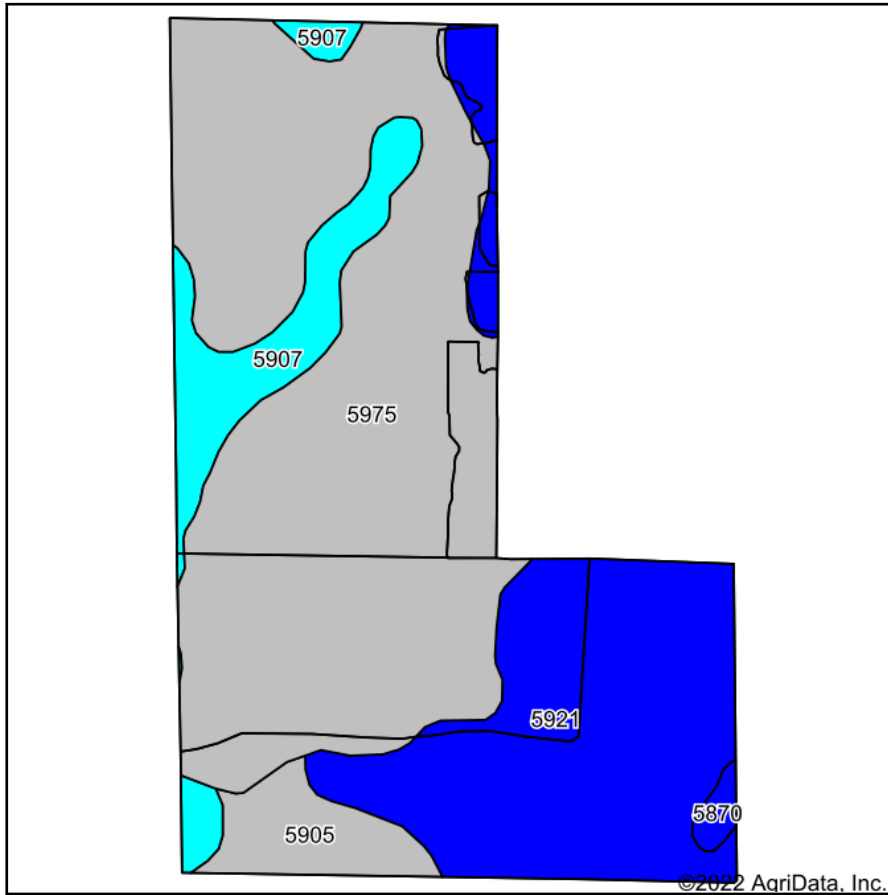

Maps Provided By:



Area Symbol: KS155, Soil Area Version: 18

Code	Soil Description	Acres	Percent of field	Non-Irr Class Legend	Non-Irr Class *c	Irr Class *c	Range Production (lbs/acre/yr)	*n NCCPI Soybeans
5975	Turon-Carway complex, 0 to 5 percent slopes	101.01	57.3%		IIIe	Ile	3220	49
5921	Ost loam, 0 to 1 percent slopes	50.33	28.6%		IIc	Ie	3060	70
5907	Langdon fine sand, 0 to 15 percent slopes	15.49	8.8%		Vle		1875	24
5905	Hayes-Solvay loamy fine sands, 0 to 5 percent slopes	8.19	4.6%		IIIe	IIIe	2700	50
5870	Carway and Carbika soils, 0 to 1 percent slopes	1.20	0.7%		IIw	IIw	5600	54
Weighted Average					2.97	*-	3048.1	*n 52.9

*n: The aggregation method is "Weighted Average using all components"

*c: Using Capabilities Class Dominant Condition Aggregation Method

*- Irr Class weighted average cannot be calculated on the current soils data due to missing data.

Soils data provided by USDA and NRCS.